

# Value-Top

## TU100M/TU200M USER MANUAL



TU100M



TU100MH



TU200M

### 1 Disassembly of side panels

- ① Unscrew the 2 screws at the rear ends of the left side panels
- ② Slide out the left side panel backward

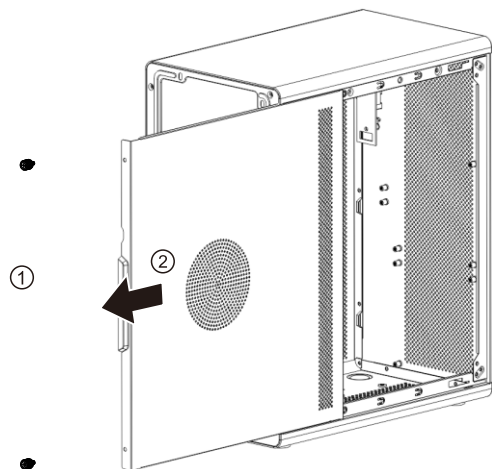

### 2 M/B installation

Put M/B in the chassis and align the screw holes, then fix M/B by screws as shown in the following illustration (this case support ITX/micro ATX M/B)  
(different M/B has different installation characteristics, please refer to the user manual of your M/B before installation)

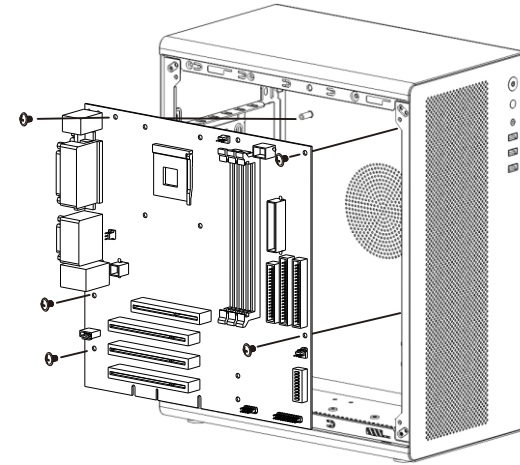

### 3 PSU installation (Support ATX PSU)

Install PSU to the position as shown in the illustration, fix it by screws at **a** positions

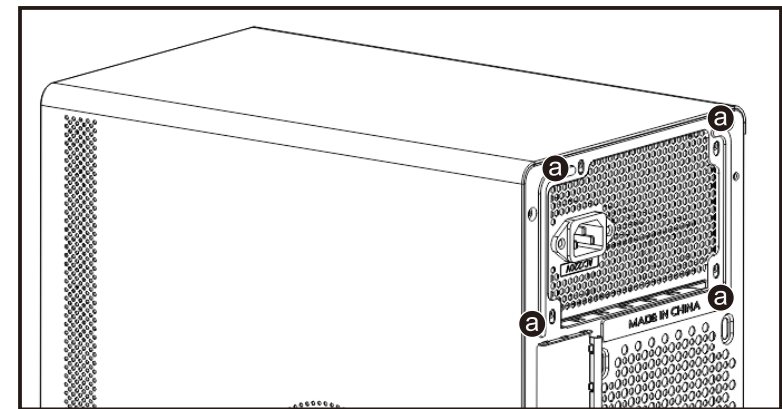

## 4 VGA card installation

- ① Unscrew the screws of the fastening bar of the PCI slot covers, remove the fastening bar, then break off PCI slot cover(s)
- ② Insert VGA card into the VGA card slot of M/B according to the arrow direction, then fix it by screw

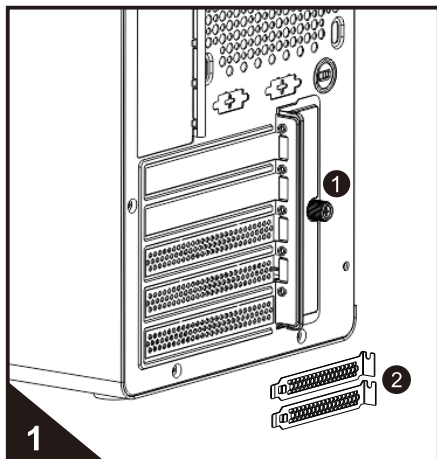

Unscrew the screws of the fastening bar of the PCI slot covers, remove the fastening bar  
break off PCI slot cover(s)

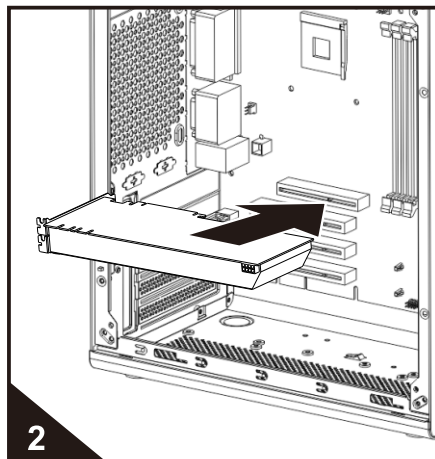

**Insert VGA card in the VGA card slot of M/B according to the arrow direction**

## 5 HDD/SSD installation (Support HDD\*1+SSD\*2 or SSD\*3)

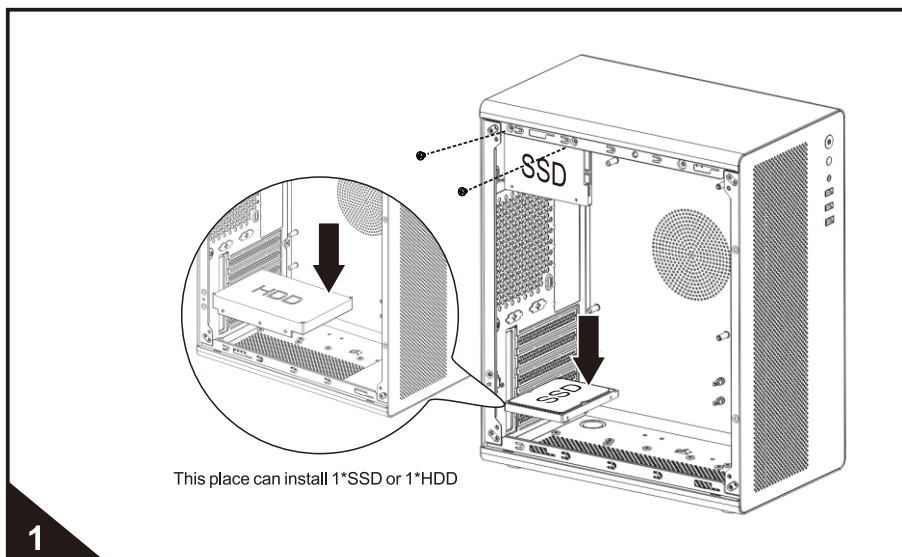

- ① 1\*2.5"SSD can be installed on the side position of top panel as shown in the illustration  
(Note: SSD installed here can only fixed by 2 screws.)
- ② 1\*2.5"SSD or 1\*3.5"HDD can be installed on bottom panel at rear end position as shown in the illustration, fix SSD or HDD by screws from the bottom  
(caution: bottom panel can not be installed 2"HDD in the meantime)

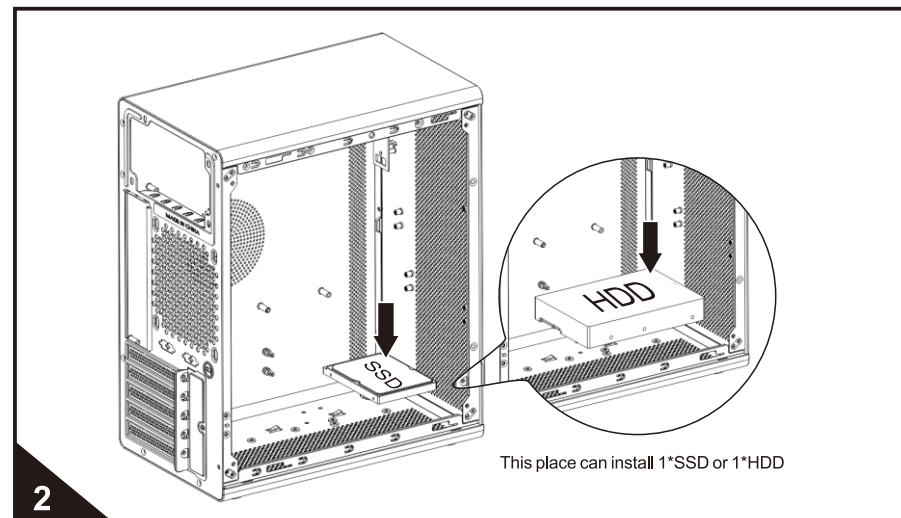

1\*2.5"SSD or 1\*3.5"HDD can be installed on bottom panel at front end position as shown in the illustration, fix SSD or HDD by screws from the bottom (caution: bottom panel can not be installed 2"HDD in the meantime)

## 6 Cooling device compatibility

Front panel: 3x12cm fan  
Rear panel: 1x12cm fan

